

Alkira Motel

213 Sharp Street
Cooma NSW 2630

Alkira Motel is a nice family motel located in Cooma. All rooms are ground floor accommodation. Room service is available for breakfast and dinner. The motel provides Austar, Broadband Internet and in-house movies. Discounted room rates are available for business, motoring associations and Senior citizens There is one accessible room with flat entry but no handrails in the bathroom and there is another room with a small step (a temporary ramp is available for entry) which does have rails in the bathroom.

Reservations:

Phone: 02 6452 3633
Fax: 02 6452 7022
Email: alkira@snowy.net.au
Web: www.alkiramotel.com.au
TTY: n/a

Transport:

Transport is easiest via private car or coach. The Transborder Alpinexpress bus takes you to Cooma town centre which is approximately 5 minutes drive from the Motel. You may also travel on REX Airlines to Cooma airport which is approximately 10 minutes drive from the motel, however, there is no wheelchair accessible taxi service available in Cooma.



Parking:

The Alkira motel has an undercover area outside the reception for temporary parking while checking in. Each room has its own dedicated parking space directly outside the room. The surface of the parking area is smooth bitumen.

Reception:

To enter reception there is one step (height 160mm) and there are 2 doors (minimum door width 760mm) the outer screen door has a lever handle and the inner wooden door has a knob handle (height 1000mm). Reception area is clearly signposted and the counter is 1080mm height. There is adequate circulation space in the reception room which has a tiled floor. It is possible to call on or before arrival to organise staff to assist with check-in and bypass the trip into reception.



Accommodation:



There is a clear accessible path of travel (approximately 10m from the parking space outside the room to the entry door). There is one small step at the door (height 120mm) with a temporary ramp available if requested at the time of booking. The door is inwards opening, door width 750mm, with a knob handle at 1100mm and no automatic door closer.

The first light switch on right hand side is at 1280 mm and the phone is also beside the entrance at a height of 1150 mm. The television has a remote control. There are no switches within 500mm of internal corners, however, there are a few switches at the back of the tea making counter which may be difficult to reach. The hanging space is available in a closet (height 720mm).

Tea/toast making facilities are available with a counter height of 900 mm. There is no knee space at the counter but there is a table that is 750 mm high with a clear knee space of 700 mm on a pedestal stand.

There is adequate circulation space around most of the room, however, there is a space of only 350mm between the double and single bed corners which could be difficult to negotiate. It is possible to request removal of the single bed for the duration of your stay to increase circulation space if required. The floor surface is carpet in the main bedroom area and tiled in the tea making and bathroom areas.

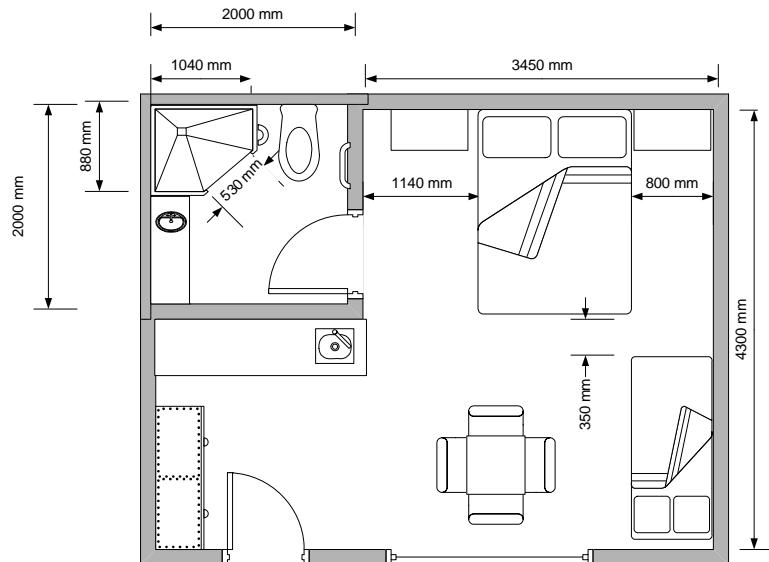

There is a space of 1140 mm on the bathroom side of the bed. The bed height is 560mm with a space of 130mm underneath, the bed is on wheels and therefore would be difficult to raise.

Alkira Motel

The bathroom is not specifically designed for wheel chair use, however, it may be adequate for some people with mobility aids. The entrance door to the bathroom is minimum width of 770mm, the door has a knob handle at 1120mm height and opens inwards. The circulation space in the dry area of the bathroom is 2000 x 2000 mm. The shower is relatively small, dimensions 880 x 1040 mm and the entrance to the shower is 530 mm wide with a 45mm step down. There are 2 grab rails in the shower, both are 960 mm high. The regular fixed shower rose height is 1800 mm with capstan knob tap at 1150 mm. A hand held shower rose and a chair for use in the shower is available upon request (when booking).



The toilet is front transfer with only 240mm space on either side. The height of the seat is 440mm and the front of the seat to the rear measures 740mm. There is a diagonal grab rail on one side of the toilet (minimum height 840mm) and a vertical grab rail on the other side (minimum height 730mm).

The wash basin is 800 mm high with 670 mm knee space and a depth 380 mm. The taps are capstan located sideways at 850 mm height. The minimum mirror height is 1200mm and the hair dryer is at 1700mm.

Other Facilities:

There is a barbecue area opposite to reception. All utensils are available at reception. The height of the BBQ/counter is 870 mm. There is a small step of 60 mm to get to the picnic table.

Emergency:

A documented emergency procedure is displayed on the door of each room. The alarm is audio and a Warden will seek to evacuate guests to safe refuge.