

Cottonwood Lodge (CWL)

3-5 William Street
Berridale NSW 2628

Cottonwood Lodge offers motel style accommodation, including family accommodation options. Rooms are ground floor with ensuite, refrigerator and television. The lodge is generally spacious and accessible with wide doors, adequate circulation space and single floor design. There is one family room and one double room which, they are not specifically designed for wheelchair accessibility, however, they are fairly accessible and may be used by wheel chair users who have some mobility. There is also a pool and a gym available for use.

Reservations:

Phone: (02) 6456 3374
Fax: (02) 6456 3999
Email: david@cottonwoodlodge.com.au
Web: www.cottonwoodlodge.com.au
TTY: n/a

Transport:

Transport is available via private car or coach, the Transborder Alpinexpress bus takes you to Lion's Park in the main street of Berridale (which is less than 1 km to the lodge) and the path of travel is via the quiet roads of Berridale. If you travel to Cooma airport on REX Airlines an accessible Taxi service is available to be booked for transport.

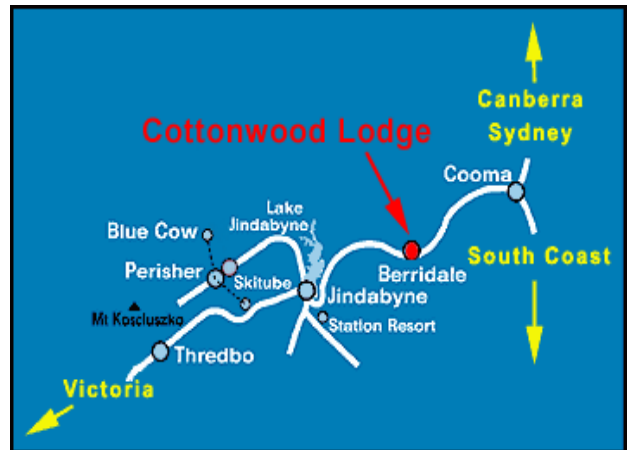

Parking:

There are 2 entrances to the lodge. The front entrance is a compacted gravel driveway and parking area which leads to the. The rear parking area provides ample parking, however, does not have a designated disabled parking space. Access from the rear carpark is through a narrow, heavy door and corridor. Assistance may be required and staff can accommodate if required.



Cottonwood Lodge

Entry:

Compacted gravel parking leads to a slated, flat, pull door entrance (door width 800mm). The door is easy to open with one hand and has an automatic door closer. The entrance has clear signage and is good lighting.



Reception:

From the entry the first door on the left leads, through is a clear accessible path of travel, to the reception counter. The counter height is 1060mm, the floor surface is carpet and there is adequate circulation space.



Bedrooms:

Room # 8 – Double Room

Access from reception to the room is via a wide corridor. The door (width 790mm) has a key lock and knob style door handle (height 1070mm) there is no automatic door closer and the entry to the room is flat. Switches are not within 500 mm of internal corners and are at a height of 1400mm, the television operates with a remote control. The height of hanging space in the room is 1300mm.

The room is small, however, there is adequate space to transfer onto the bed from one side (1500mm, see floor plan) furniture may be removed to add extra circulation space if requested on booking. The bed height is 530mm with 130mm underneath. The bed is on a wheel



Cottonwood Lodge

base therefore it is unlikely it could be raised unless specialised blocks were used.

Bathroom

There is an inwards opening door (width 810mm) with a knob handle (height 1070mm), there is no automatic door closer. The toilet is right hand transfer with 1100mm distance to the wall. The height of the seat is 400mm and front to rear is 700mm. There is no grab rail at the toilet. The basin is 800mm height with no knee space as there is shelving under the basin. Taps are capstan.

The shower has a small lip (20mm) to enter, a narrow door and glass surrounds. There is one diagonal grab rail in the shower which is 300mm long, top height is 1460mm low height of 1200mm. A portable shower chair is available on request. The shower rose is fixed and the taps are star capstan at a height of 1300mm.

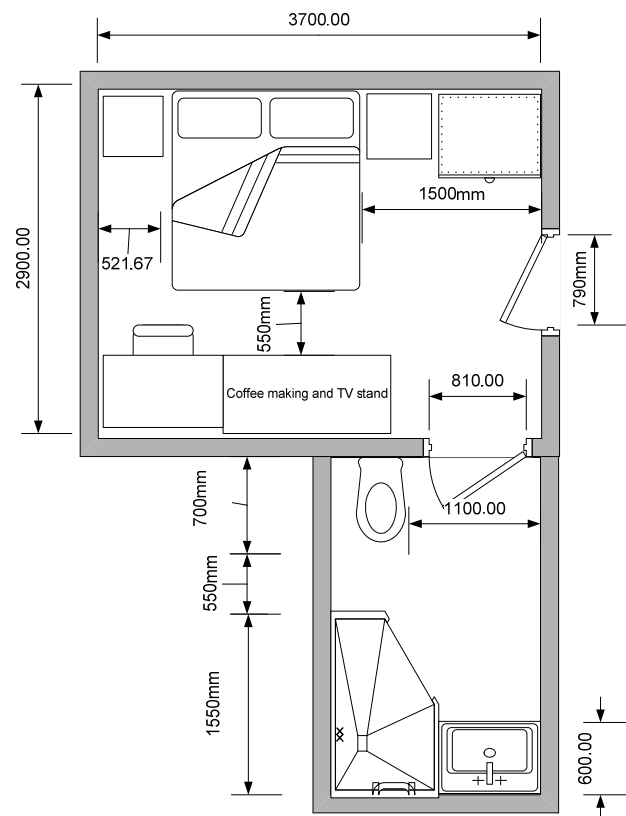

Communal Dining/ Lounge Area:

Cottonwood lodge has a communal dining area, bar, games room and log fire/lounge area all on the same level as the rooms. Continental breakfast is offered in the dining area. The height of the benches is 910mm and the tables are at a height of 740mm with knee space 736mm and pedestal stands.

Cottonwood Lodge



Other Facilities:

There is a gym and a pool also available for use which has a flat but slightly uneven path of travel. The area surrounding the pool is flat, however, there is no ramp into the pool. Entry to the gym has one step.

Emergency:

A documented emergency procedure is displayed on the door of each room. The alarm is audio and a Warden will seek to evacuate guests to safe refuge. Each building has a number of emergency entry/exit points. Exit from the site would be via the front or rear driveways.